



Custom Dynamics® Saddlebag Dual Color LED Latch Lightz™ Installation Instructions

We thank you for purchasing the Custom Dynamics® Saddlebag Dual Color LED Latch Lightz™. Our products utilize the latest technology and high quality components to ensure you the most reliable service. We offer one of the best warranty programs in the industry and we back our products with excellent customer support, if you have questions before or during installation of this product please call

Part Numbers: CD-SBL-DC-RB CD-SBL-DC-RC
CD-SBL-DC-SB CD-SBL-DC-SC
CD-SBL-DC4-RB CD-SBL-DC4-RC
CD-SBL-DC4-SB CD-SBL-DC4-SC

Package Contents:

- Saddle Bag LED Latch Lightz™ w/ Hinge Cover(2)
- BCM Y Harness Adapter w/ Plugs (1)
- Quick disconnect Harness (2)
- 4" Tie Wraps (10)
- Tie Wrap Holder (8)
- Foam Strip (2)

CD-SBL-DC Fitment: 2014-2023 Harley-Davidson® Street Glide (FLHX), Street Glide Special (FLHXS), Ultra Limited (FLHTK), 2015-2023 Road Glide (FLTRX), Road Glide Special (FLTRXS), 2017-2023 Road King Special (FLHRXS), 2022-2023 CVO™ Road Glide Limited (FLTRKSE), 2020-2023 Road Glide Limited (FLTRK), 2014-2019 Electra Glide Ultra Classic (FLHTCU), 2015-2016 Ultra Classic Lo (FLHTCUL), 2016 CVO™ Road Glide Ultra (FLTRUSE), 2016-2019 Road Glide Ultra (FLTRU), 2015-2018 Ultra Limited Lo (FLHTKL) and 2016-2021 CVO™ Limited (FLHTKSE).

CD-SBL-DC4 Fitment: 2014-2022 Harley-Davidson® Road King (FLHR), 2014 CVO™ Road King (FLHRSE), 2022-2023 Street Glide ST (FLHXST) & Road Glide ST (FLTRXST), 2015-2022 CVO™ Street Glide (FLHXSE), 2018-2022 CVO™ Road Glide (FLTRXSE), 2015 CVO™ Road Glide Ultra (FLTRUSE), 2014-2015 CVO™ Limited (FLHTKSE) and 2019-2022 Electra Glide Standard (FLHT).



Installation:

1. Secure motorcycle on level surface. Remove seat. Disconnect the negative battery cable from the battery.
2. Locate and unplug the lighting connector to the rear fender.
3. Plug the provided BCM Y Harness Adapter, in-line, into the rear lighting harness and into the bike's main wiring harness.
4. Open saddle bag lid and remove any personal items from the saddle bag.
5. With the saddle bag open, disconnect the check strap from the lid of the saddlebag. Save the hardware for reassembly. The saddlebag lid will need to remain fully open to the outside of the saddlebag. Take protective measures so the saddlebag and/or lid are not damaged during the rest of the installation.
6. Remove the hinge cover from the hinge and locking mechanism.
7. Install the Saddlebag LED Latch Lightz™ in place of the OEM hinge cover on the saddlebag hinge.
8. Reinstall the check strap to the saddlebag lid.
9. Install the provided foam strip on the top outside lip of the saddle bag as shown in Photo 1.
10. Route wire from Saddlebag LED Latch Lightz™ over the foam pad and around to the front of the saddlebag towards the locking latch. Secure the wire to the inside of the saddlebag using the provided tie wrap holders and tie wraps as shown in Photo 2. Clean the mounting locations of the tie wrap holders with denatured alcohol before pressing into place.



ATTENTION

Please read all Information below before Installation

Warning: Disconnect negative battery cable from battery; refer to owner's manual. Failure to do so may result in electrical shock, injury, or fire. Secure negative battery cable away from positive side of battery and all other positive voltage sources on vehicle.

Safety First: Always wear appropriate safety gear including safety glasses when performing any electrical work. It is highly recommended that safety glasses be worn throughout this installation process. Be sure vehicle is on level surface, secure and cool.

Important: This product is designed and intended for use as auxiliary lighting only. It is NOT intended to replace any original equipment lighting installed on the vehicle and should not be used for that purpose. This product must be wired so that it does not interfere with any original equipment lighting.

Important: Ambient install temperature must be 60 degrees F or higher. Allow 24 hours for tape to cure before washing or prolonged use of vehicle.

Note: The Y Harness Adapter must be plugged into the output (behind) any Smart Signal Stabilizer™/load equalizer or any brake strobe modules.

Questions? Call us at: 1 (800) 382-1388 M-TH 8:30AM-5:30PM / FR 9:30AM-5:30PM EST

Installation Continued:

11. Remove saddlebags from the motorcycle. Transfer the saddle bags to a protected work area to prevent scratches.
12. Using a grease pencil, mark desired drill point for the Saddlebag Latch Lightz™ wire to exit the saddle bag. It is recommended the drill hole is located approximately 1" below the saddle bag latch as shown in Photo 3. Apply masking tape to the outside of the saddlebag at the marked drill point.
13. Using a 9/16" drill bit, drill a hole through the marked drill hole on each saddlebag. Drill from the outside of the saddlebag to the inside then remove masking tape. It is recommended to start with a smaller drill bit and work up to a 9/16" drill bit.
14. Route wire from each Saddlebag LED Latch Lightz™ through the 9/16" hole and out the backside of the saddle bag. Install the grommet in the 9/16" hole in the Saddlebag.
15. Reinstall saddlebags and plug in the male JAE connectors from each Saddlebag LED Latch Lightz™ to the female JAE connectors (black) of the quick disconnect harness.
16. Plug the quick disconnect harness into the BCM Y Harness adapter.
17. Secure wires under the seat with tie wraps to secure wires from becoming cut, frayed, or pinched.
18. Reinstall motorcycle seat and connect the negative battery cable to the battery.
19. Test operation of all lighting before riding.

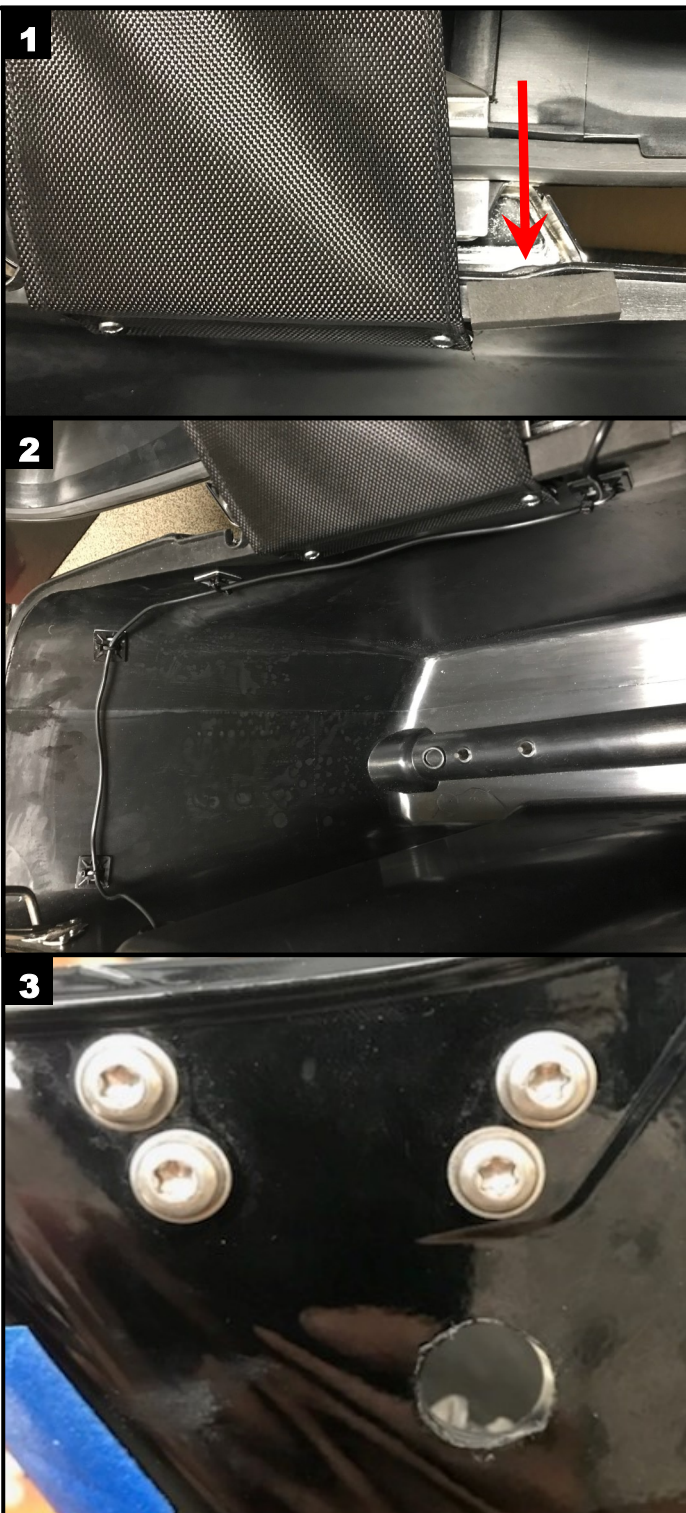

Installation Instructions - Page 3

CD-SBL-DC : Brake Strobe Modification with MAGIC-STROBES-RSG.

This modification will allow the Dual Color Latch Lightz to strobe when used with a MAGIC-STROBES-RSG (sold separately).

The YELLOW brake wire in the pigtails of the BCM Y Harness adapter must be cut and the long red wire connected to the brake output wire of the MAGIC-STROBES-RSG module.

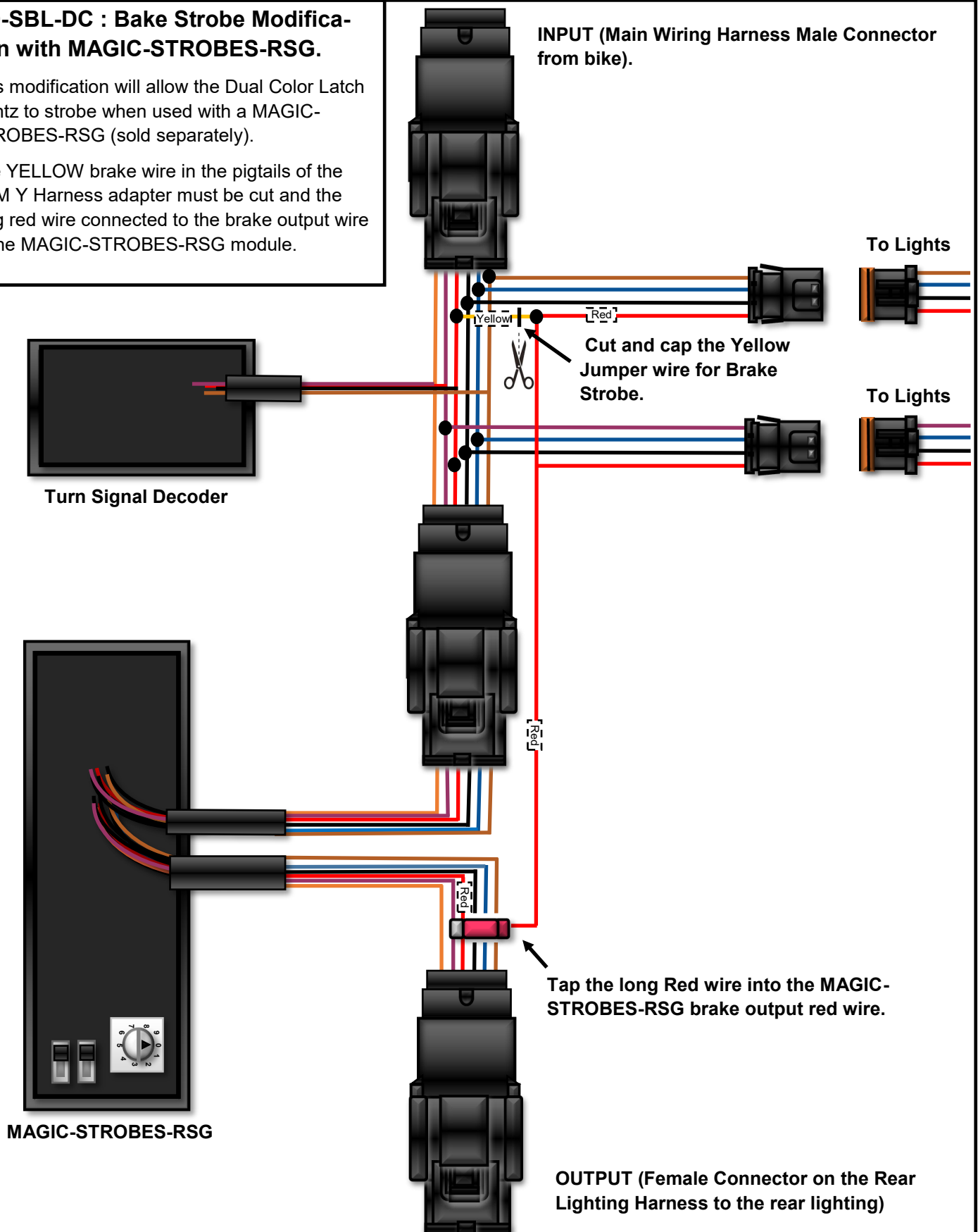

Installation Instructions - Page 4.

CD-SBL-DC4 : Brake Strobe Modification with GEN-SMART-TPU-BCM

This modification will allow the Dual Color Latch Lightz to strobe when used with a GEN-SMART-TPU-BCM (Sold Separately).

The RED brake wire in the pigtails of the BCM Y Harness Adapter must be cut and connected to the brake output wire of the Triple Play BCM module.

GEN-SMART-TPU-BCM

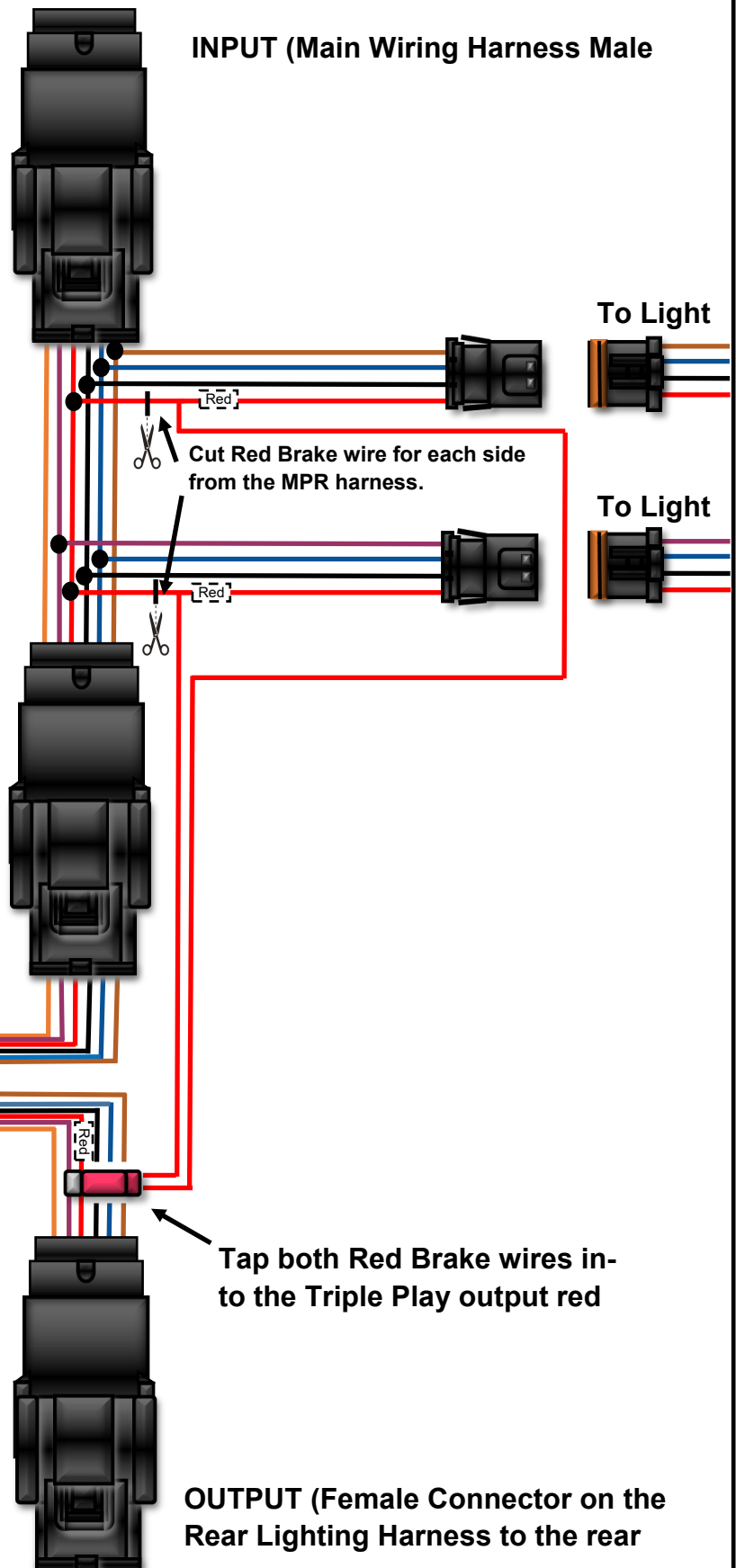
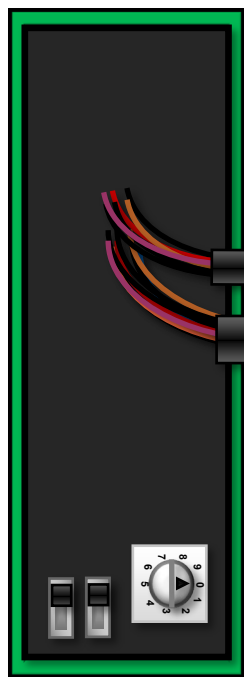

Questions? Call us at: 1 (800) 382-1388 M-TH 8:30AM-5:30PM / FR 9:30AM-5:30PM EST