

INSTALLATION AND USER INSTRUCTIONS

Pro-Comp Full Exhaust Install

Indian Challenger and Pursuit Models



Included Components:

Front and Rear Cylinder Down Pipes w/Replacement Factory Gaskets

Collector Y-Pipe Assembly

Single Pro-Comp Muffler Assembly

Exhaust Mount Capture Bracket

Right Side Bag Support Pad Mount

(2) Black Foot Rest Spacers

Left Bag Support

Bolts and Hardware:

(1) M6x30mm Socket Head Screw + washer for left bag support

(6) M8x20mm Hex Head Screws

(8) M8 Flat Washers

(6) M8 Lock Washers

(2) M8x30mm Socket Head Screws

(2) M6x14mm Socket Head Screws

(4) M6 Flat washers

(2) M6 Locknuts

(3) Springs

DISCLAIMER

Toce Performance recommends professional installation for its entire product line. These directions are a point of reference for installing components onto a vehicle. These directions should be combined with an experienced installer to ensure proper fitment to eliminate the possibilities of catastrophic failure, damage to vehicle, persons or others. We recommend to specifications to follow stainless steel bolt size spec, or factory specification (whichever is higher) when mounting and replacing components. Toce also recommends checking your vehicle prior to each session to ensure all components are fixed to the vehicle properly. Failure to safety inspect vehicle bolt ons could result in failure. Toce Exhaust Systems are performance oriented exhaust systems designed for racing applications and should NOT be used on public roads and highways. Toce always recommends remapping the vehicles computer for the changes to the exhaust system and other modifications to ensure the best performance is available.

Copyright © 2023 by Toce Performance

All rights reserved. No part of this publication may be reproduced, distributed, or transmitted in any form or by any means, including photocopying, recording, or other electronic or mechanical methods, without the prior written permission of the publisher. For permission requests, write to the publisher, addressed "Attention: Permissions Coordinator," at the address below.

Toce Performance, 150 Batson Dr. Manchester CT, 06042

IMPORANT INFORMATION

WARNING! We recommend professional installation of any of our exhaust systems and other components. Failure to properly install components could not only lead to catastrophic power & drivetrain failure. But could result in injury to the rider, passenger or others!

CAUTION! Exhaust systems are HOT! We recommend doing the installation while the vehicle is at room temperature and has not been run for a period of time to ensure nothing is hot enough to harm the installer.

Read and understand this manual and its safety instructions before using this product. Failure to do so can result in serious injury or death.

Keep all safety information and instructions for future reference and pass them on to subsequent users of the product.

1.) Obtaining documentation and information

1.1.1 Internet

The latest version of the documentation is available at the following address:

<http://www.toceperformance.com>

1.1.2 Ordering documentation

Documentation, user instructions and technical information can be requested by calling Toce at 860-289-7275

1.1.3 Documentation feedback

Any comments can be submitted on the support website. Comments can also be sent support@toceperformance.com

We appreciate your input.

2.) The Capture Bracket

You'll notice that the Challenger/Pursuit system came partially assembled. This is to ease the installation process with the capture bracket as shown below.

This bracket is designed to support the exhaust assembly and offer the same strength and rigidity as the factory system. Installation process only requires installing two of the M8x20mm Bolts in the bottom "T" Bracket to the vehicle

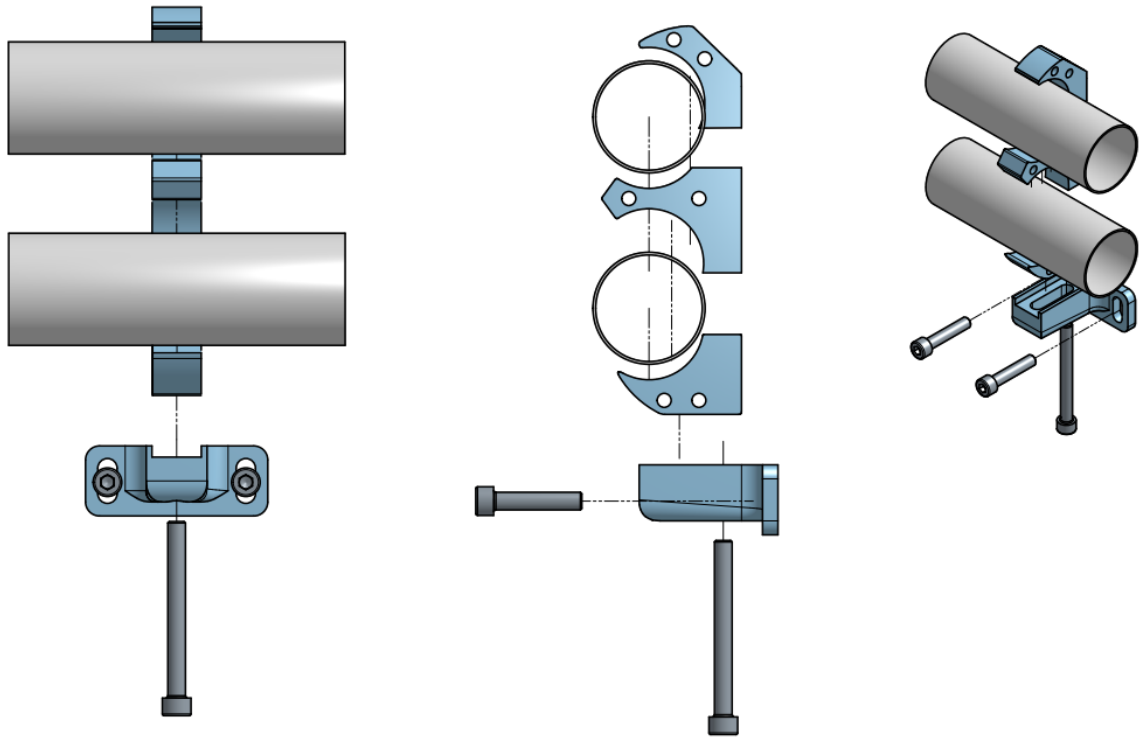

3.) Prepping for Installation.

Begin with removing the rear bags (and rear fender if installing the billet support). See your owners manual for proper removal of the units. Be mindful that bag lights must be unplugged prior to removing the assembly, as well as the antenna on the challenger models. Remove the right footrest assembly and let it sit on something so it doesn't need to be completely removed.



Proceed with loosening the header down tube bolts and oxygen sensors from each pipe. Unbolting the rest of the exhaust mount bolts, and remove the factory exhaust from the vehicle. Prep placing the Toce Exhaust into place by slightly loosening the capture bracket bolt pictured. This will allow for a bit of play for aligning the headers to the block.



4.) Main Assembly

Install the collector assembly onto the tubing and attach the supplied springs to the down tubes with the “bag pad” facing up. Mount the oxygen sensors to each down tube. Install the supplied factory replacement exhaust gaskets, and secure the down tubes to the engine block snug. (Shown without shields)



Mount the capture bracket. M8x20mm Hex bolts, lock washers and flat washers snug.

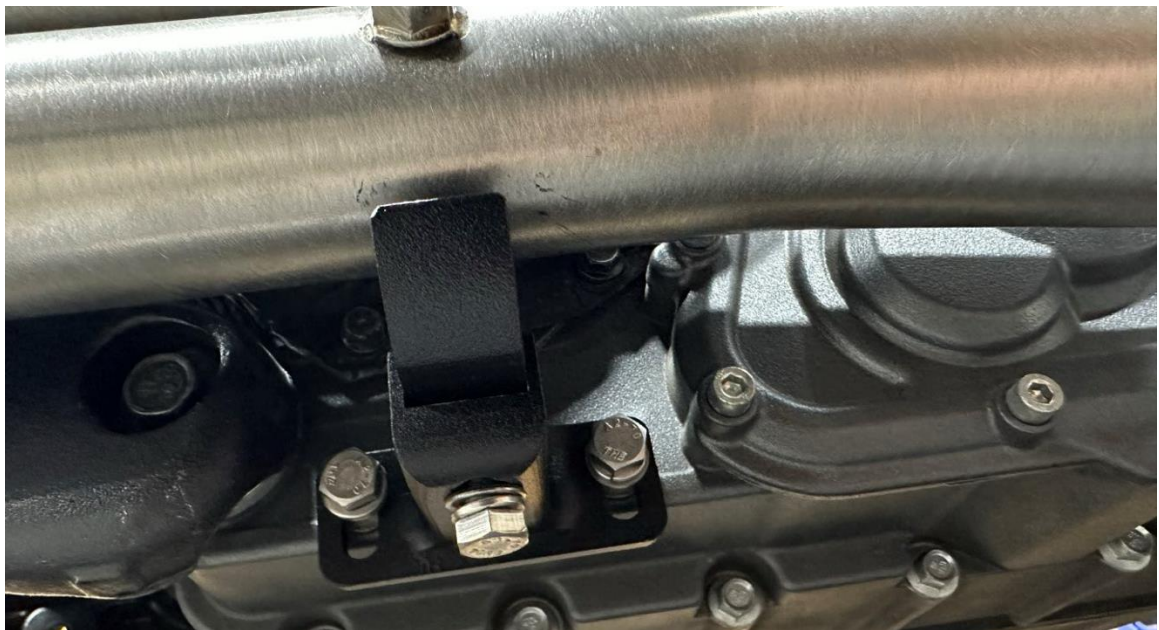

Install the canister assembly to the Y-pipe and affix to the factory mounting location on the subframe support. Install antenna mount if equipped/kept between mount and can.



On the left side of the vehicle, remove the muffler assembly (if you hadn't when removing the whole system). Mount the supplied bag support arm with the bag pad facing up like the right side.

Shown below with the optional subframe attachment. The supplied arm will mount to the factory mounting location and the lower tab can be cut off for aesthetics if you choose.

The bag support will attach itself in the front to the lowest hole in the frame using an M6x30mm Socket Head Cap Screw, flat and lock washer through the drilled slot on the arm.



5.) Final Touches

Place the fender, bags and original components back onto the vehicle loosely.

Install the fender assembly and secure. Ensure the left side back is supported by the bag support and tighten the bag to the fender.

Install the right side bag and adjust the y-pipe bag pad at a point where it's supporting the bag. Tighten the bolts on the pad mount.



Note that the Capture bracket can help add additional height if needed. Ensure its positioning is allowing a smooth flow from heads to canister. There should not be any pressure of the system applying against itself.



Proceed to tighten down tubes to the heads to factory specification. Onto the capture bracket's clamping bolt. The bolts to the block. Finally onto the canister bolts to the factory mount. At this point check the bag support and if in place well, tighten down the bag mounts. Mount the brake/foot rest back to the vehicle. If the unit wants to touch the exhaust, simply install the included black spacers between the frame and rest.

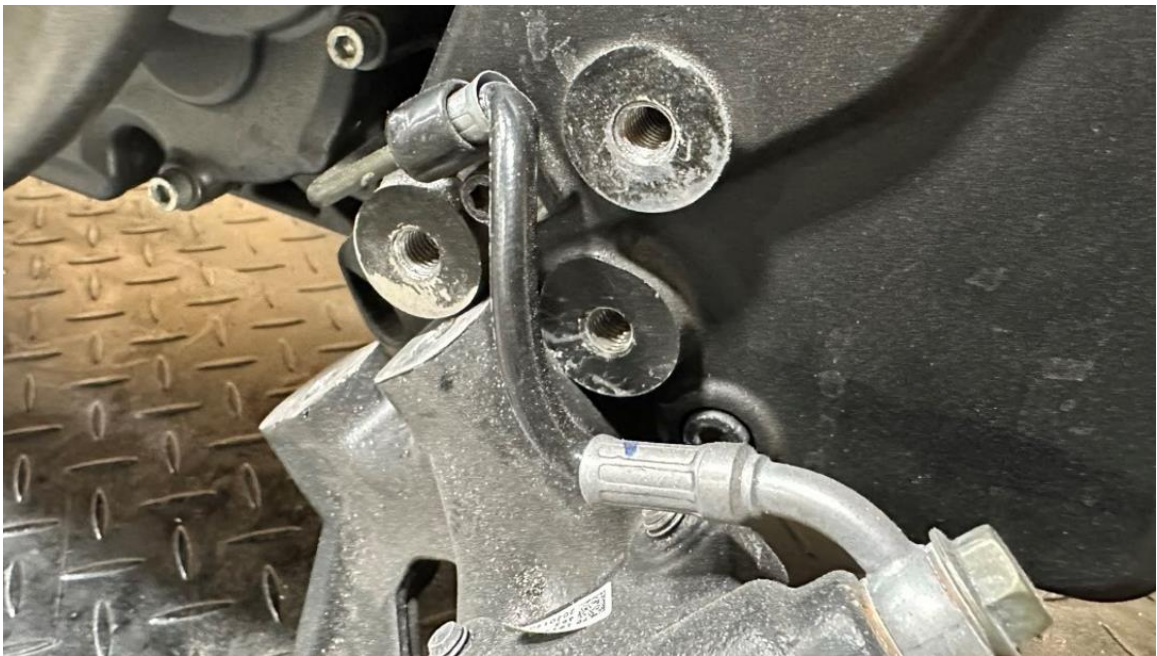

6.) Installing Optional Billet Bag Support

Each side of the bag supports are indicated with an L and R for left and right of the vehicle while standing behind it. Below is the assembly of the main unit.



Note that the left bag support and the right side canister mount are affixed to the sub frame assembly from the inside and bolted from the inside. As shown. Reassemble and you're done!



Please reach out to us if you have any questions and check our website and youtube for install videos if you need help!

Support@TocePerformance.com

